



DIN RAIL MOUNTING KIT

- Rugged metal bracket
- Ultramid A3X2G5 DIN rail slider
- Suitable for specific FIEPOS units / FPT500, FPT300, FPH500 and FPS300 products

Product Description

DIN RAIL MOUNTING KIT is a mechanical accessory to mount a device on a DIN rail.

One mounting set for one FIEPOS device consists of:

- 2x T-Holder
- 4x screws: TORX T10, self-tapping, 6 mm
- 1x DIN rail slider
- 1x spring
- 1x screw: TORX T10, self-tapping, 8 mm

Not included:

- M8 and M10 screws for mounting on wall or panel.
- Nuts to tighten the screws.

Order Number

DIN RAIL MOUNTING KIT

ZM.FPDRA-10 1 piece

ZM.FPDRA-11 10 sets

The information given in this document is correct to the best of our knowledge and experience at the time of publication. If not expressly agreed otherwise, this information does not represent a warranty in the legal sense of the word. As the state of our knowledge and experience is constantly changing, the information in this data sheet is subject to revision. We therefore kindly ask you to always use the latest issue of this document (available under www.pulspower.com).

No part of this document may be reproduced or utilized in any form without our prior permission in writing.

1. Intended Use

This mechanical accessory is designed for FPT500, FPT300, FPH500 and FPS300 products.
Use the kit only for products that explicitly refer in their datasheets to this DIN rail mounting kit.
Mounting example shows the isometric view from different perspectives on a field power supply:

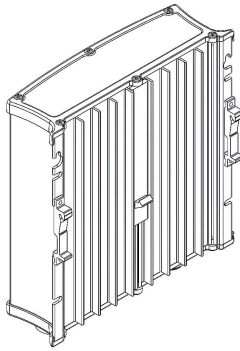

Fig. 1-1: Left view

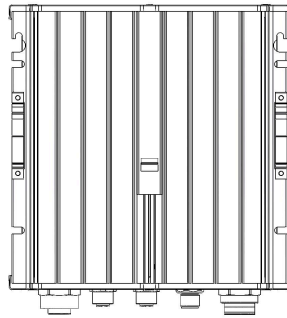

Fig. 1-2: Front view

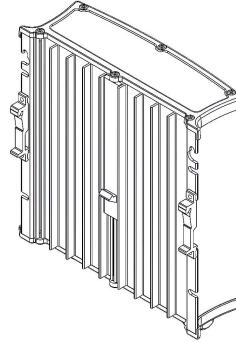

Fig. 1-3: Right view

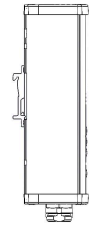
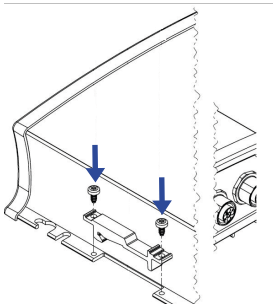
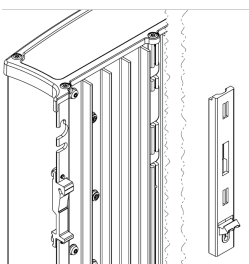

Fig. 1-4: Profile view

2. Installation Instructions



- i** Use a torque of 1 Nm to fasten the screws.
- ⇒ Attach the T-Holders with 2 screws to the front side on the unit.
- ✓ The T-Holders are now fully installed.



- ⇒ Place the DIN rail slider on the rear side of the device between the cooling fins.
- ⇒ Then push the slider up to the stop.

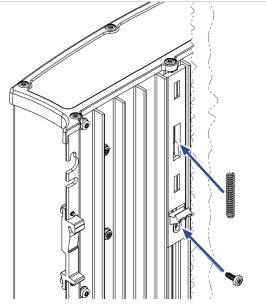

- i Use a torque of 8 Nm to fasten the screws.
- ⇒ Put the spring over the plastic guide pin, compress it and push it into the groove.
- ⇒ Fix the slider with the screw.
- ✓ The slider is now fully installed.

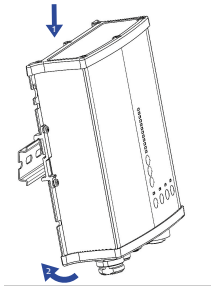

- ⇒ For mounting, place the power supply unit with the top of both T-holders on the rail.
- ⇒ Press the underside of both T-holders onto the rail until you hear a clicking sound.
- ✓ The power supply unit is now fully mounted.

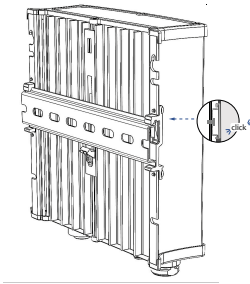

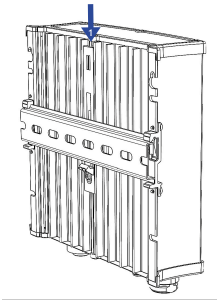

⚠ CAUTION

Do not use your finger to pull down the slider. There is a risk of injury.

- ⇨ For demounting, press the slider down with an object.
- ⇨ Pull the power supply unit forward from below.
- ⇨ Pull the power supply unit upwards.
- ✓ The power supply unit is now fully demounted.

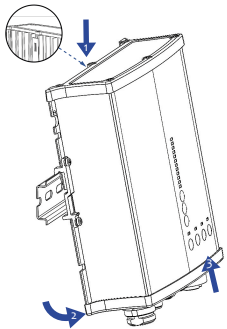

3. Physical Dimensions and Weight

	T-Holder	DIN rail slider
Width	7.5 mm	16.24 mm
Height	56 mm	117.9 mm
Depth	10.5 mm	13.6 mm
Weight	3.92 g	6.86 g
Bracket material	Zinc-plated steel	Ultramid A3X2G5

All dimensions in mm.

T-Holder

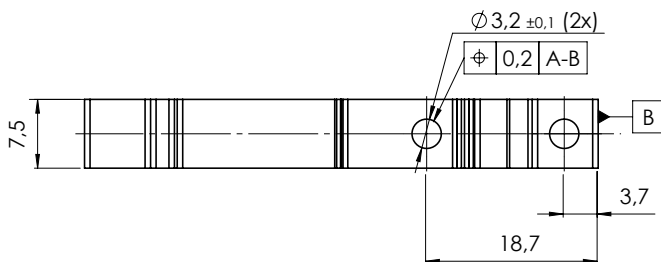

Fig. 3-1: Dimensional drawing back view

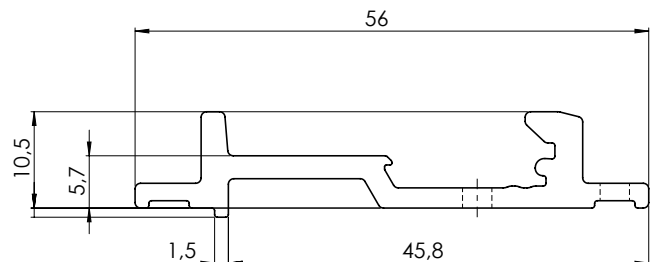

Fig. 3-2: Dimensional drawing profile view

DIN rail slider

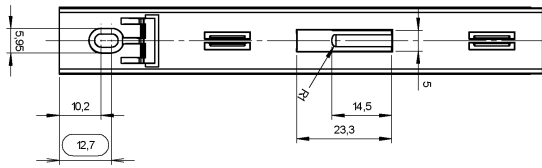

Fig. 3-3: Dimensional drawing back view

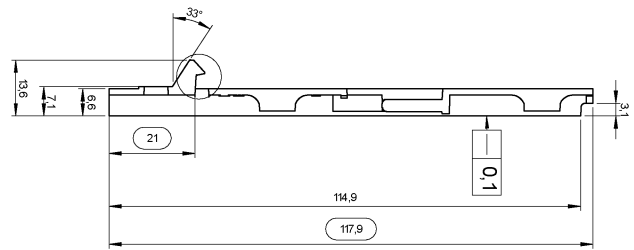

Fig. 3-4: Dimensional drawing profile view