

Read this first

This kit may only be assembled by qualified personnel.
 Caution: When assembling be aware of the risk of injury from sharp edges on the rear of the unit.
 Read the instruction manual of the FIEPOS power supply before mounting on the DIN rail. When the FIEPOS is mounted on the DIN rail assure that any sharp edges on the back cannot be accessed and cannot cause injury.

Product Description

The ZM.FPDRA-10 is a set of mechanical parts to adapt FIEPOS series products for mounting on standard DIN-Rails. The ZM-FDPRA-11 is one package, including 10 mounting sets.

- One mounting set for one FIEPOS device consists of
- 2 T-Holder
- 4 Screws: TORX T10, self-tapping, 6mm
- 1 DIN rail slider
- 1 Spring
- 1 Screw: TORX T10, self-tapping, 8mm

Intended use

This mechanical accessory is designed for FPT500, FPT300, FPH500 and FPS300 products.
 Use the kit only for products that explicitly refer in their datasheets to this DIN rail mounting kit.

Assembly Instruction

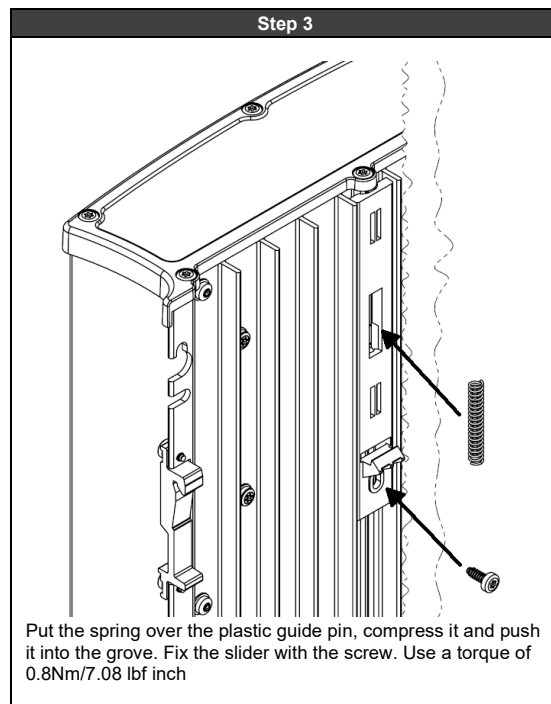
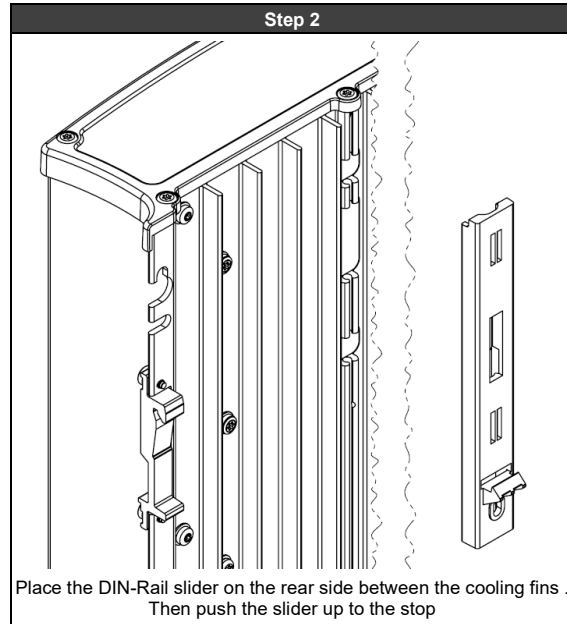
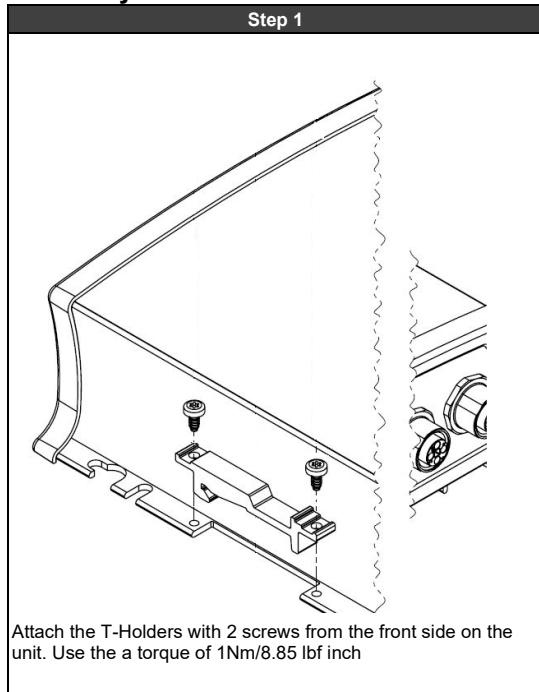

Technical Data

Size (width x height x depth)	16x126.9x13.6mm
Weight	7g / 0.015lb

Headquarters: PULS GmbH, Elektrastr. 6, 81925 Munich, Germany, www.pulspower.com
 Germany +49 89 9278 0
 China +86 512 62881820

France +33 478 668 941
 North America +1 630 587 9780

Austria +43 2764 3213
 Singapore +65 6684 2310

Switzerland +41 56 450 18 10
 United Kingdom +44 1525 841001

The information in this document is believed to be accurate and reliable and may change without notice.